



Timber Bluff

A Premier Southside Neighborhood



- 55+ Senior Condo Designation
- Condo Fee \$240: Insurance, Exterior Maintenance, Lawn & Snow
- Complete with Kitchen Appliances, Washer & Dryer
- Front Porch & Pergolas Included
- Sodded & Irrigated Lawns
- 52 Units Total

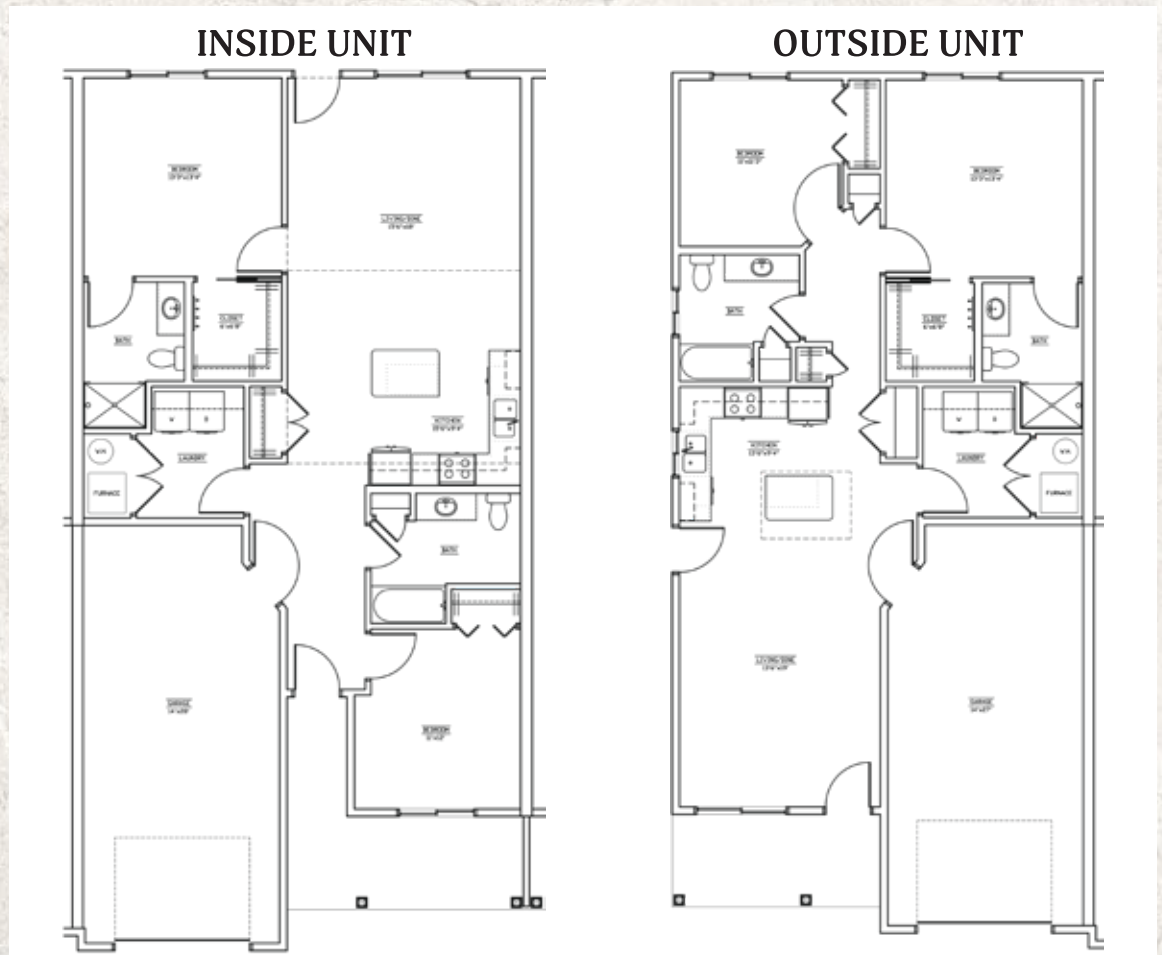

SENIOR CONDOS

STEVE WIGGINS
715.577.0092

JAKE WURZER
715.533.1696

CONTACT US FOR LOT AND BUILDING INFORMATION:

Info@WurzerBuilders.com



WURZER
BUILDERS, INC.

Quality Custom Homes

WurzerBuilders.com